



Before beginning installation procedures, these installation and operation instructions should be studied carefully. The installation and operation should also be in accordance



with local regulations and accepted codes of good practice.

1. General data
1. Applications

Fault	Cause
1. Pump does not start	a) Supply failure. b) Control circuit has cut out or is defective c) Motor is defective d) Pump is blocked by impurities.
2. Pump runs but gives no water	a) Pump is not filled with liquid. b) Suction or discharge pipe is blocked by impurities. c) Pump is blocked by impurities d) Suction lift is too great. e) Leakage in Suction pipe f) Foot or non-return valve is blocked.
3. Pump runs at reduces capacity	a) Wrong direction of rotation (three-phase) b) Suction lift is too great. c) Suction or discharge pipe is blocked. d) Pump is blocked by impurities. e) Foot or non-return valve is partly blocked.
4. Pump stops during operation	a) Thermal overload switch in motor or external motor protection cuts out. b) Control circuit has cut out.

7. Disposal

Disposal of this product or parts of it must be carried out according to the following guidelines:

1. Use the local public or private waste collection service
2. In case such waste collection service does not exist or cannot handle the materials used in the product, please deliver the product or any hazardous materials from it to your nearest. True sole agent.

CHLF,CHLF (T) 2,4

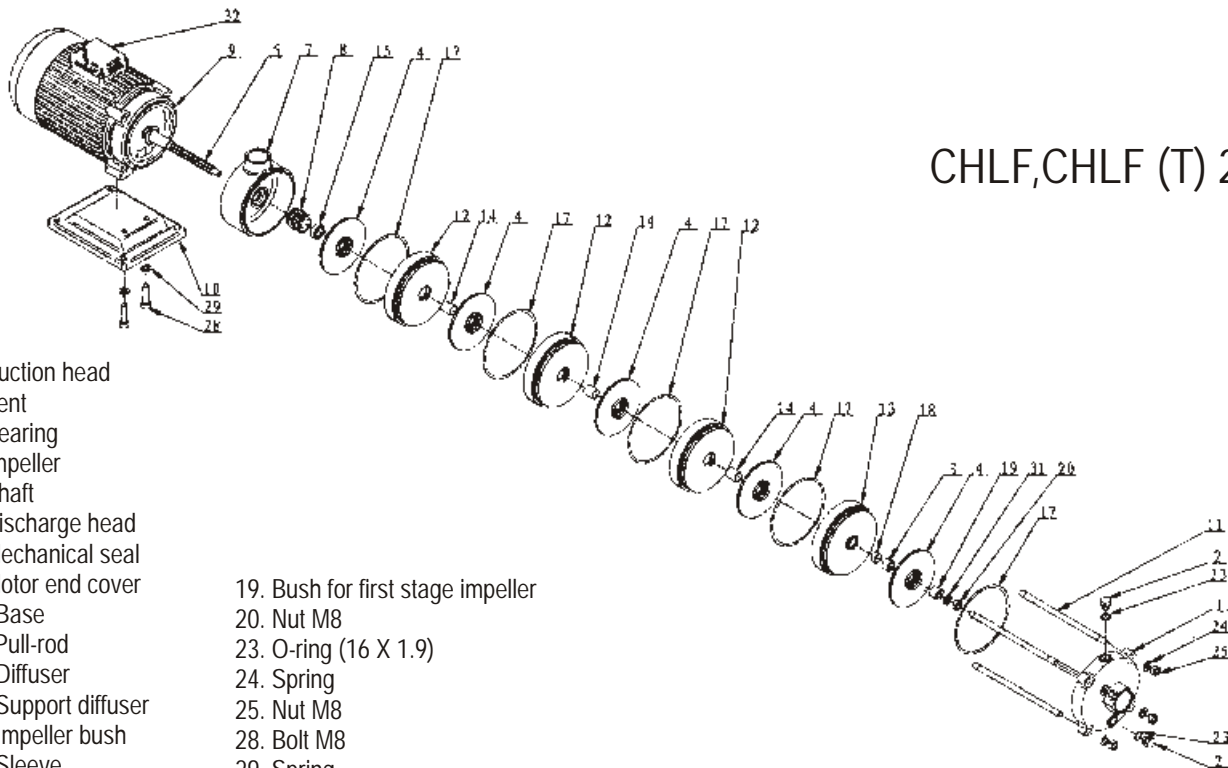

- | | |
|----------------------|-----------------------------------|
| 1. Suction head | 19. Bush for first stage impeller |
| 2. Vent | 20. Nut M8 |
| 3. Bearing | 23. O-ring (16 X 1.9) |
| 4. Impeller | 24. Spring |
| 5. Shaft | 25. Nut M8 |
| 7. Discharge head | 28. Bolt M8 |
| 8. Mechanical seal | 29. Spring |
| 9. Motor end cover | 31. Spring |
| 10. Base | 32. Motor |
| 11. Pull-rod | |
| 12. Diffuser | |
| 13. Support diffuser | |
| 14. Impeller bush | |
| 15. Sleeve | |
| 17. Seal spring | |
| 18. Impeller | |

CHL/CHLK 2,4

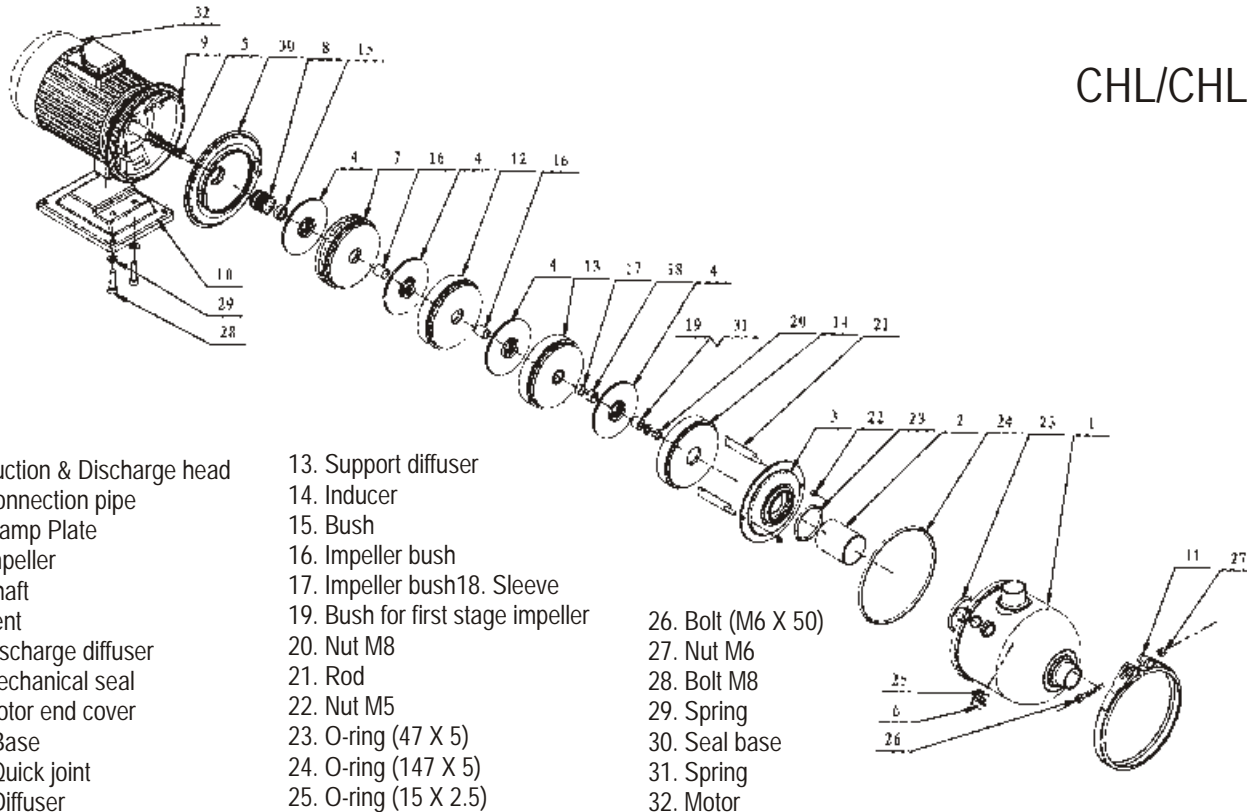

- 1. Suction & Discharge head
- 2. Connection pipe
- 3. Clamp Plate
- 4. Impeller
- 5. Shaft
- 6. Vent
- 7. Discharge diffuser
- 8. Mechanical seal
- 9. Motor end cover
- 10. Base
- 11. Quick joint
- 12. Diffuser

- 13. Support diffuser
- 14. Inducer
- 15. Bush
- 16. Impeller bush
- 17. Impeller bush
- 18. Sleeve
- 19. Bush for first stage impeller
- 20. Nut M8
- 21. Rod
- 22. Nut M5
- 23. O-ring (47 X 5)
- 24. O-ring (147 X 5)
- 25. O-ring (15 X 2.5)

- 26. Bolt (M6 X 50)
- 27. Nut M6
- 28. Bolt M8
- 29. Spring
- 30. Seal base
- 31. Spring
- 32. Motor

